

FILE NAME: C:\Users\WangMa2\OneDrive - Government of Ontario\Desktop\Chris\SS116\SS105-17\SS105-17.dwg
 MODIFIED: 2024-03-01 09:42
 MINISTRY OF TRANSPORTATION, ONTARIO
 ANS-D
 2017-08

Ontario Ministry of Transportation
 CONT WP **DRAFT**
 APPROACH SLAB WITH SLEEPER SLAB
 SHEET

METRIC
 DIMENSIONS ARE IN METRES AND/OR MILLIMETRES UNLESS OTHERWISE SHOWN
 DRAWING NOT TO BE SCALED
 100mm ON ORIGINAL DRAWING

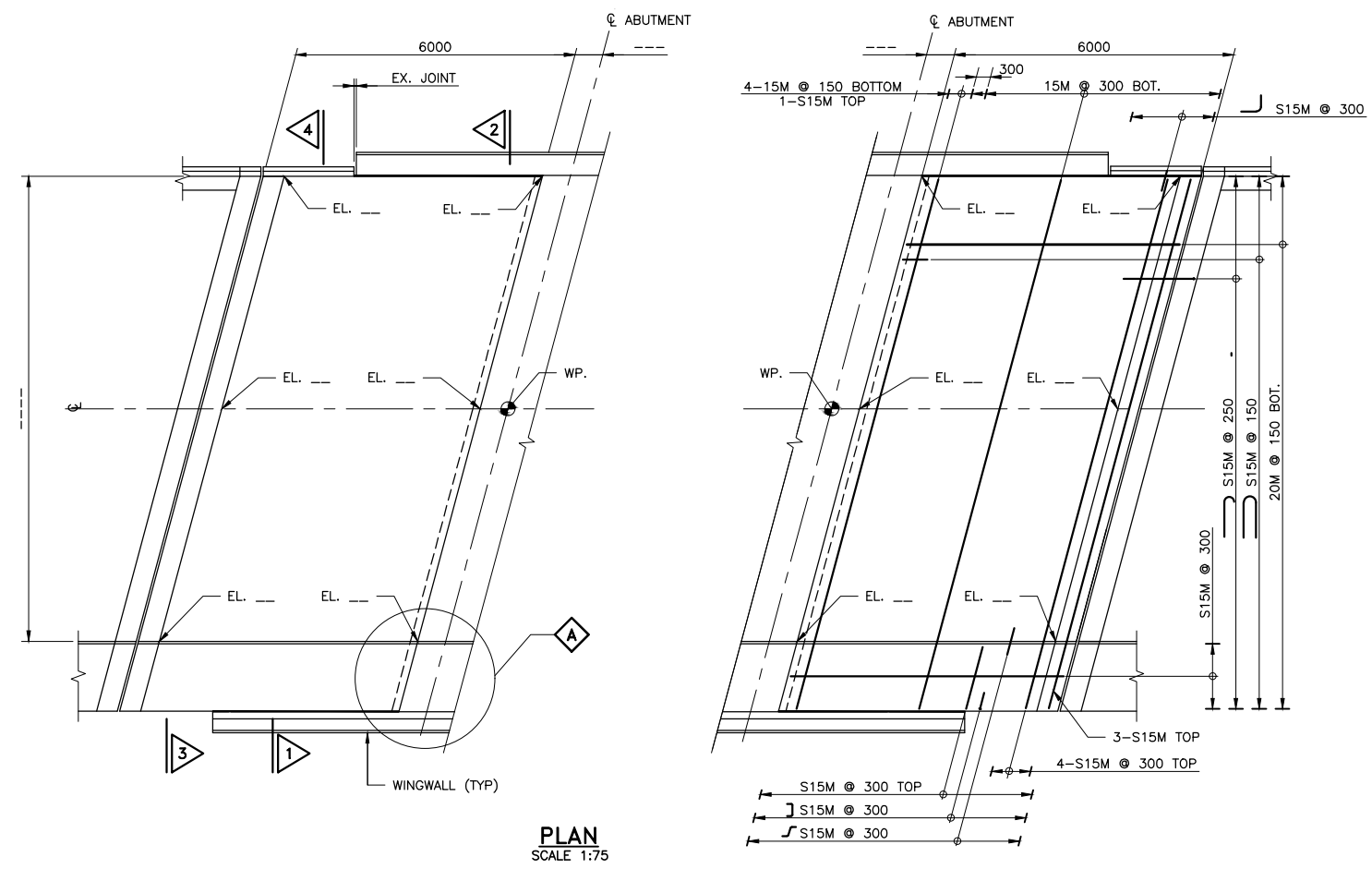

C CHASE DETAIL
 SCALE 1:2

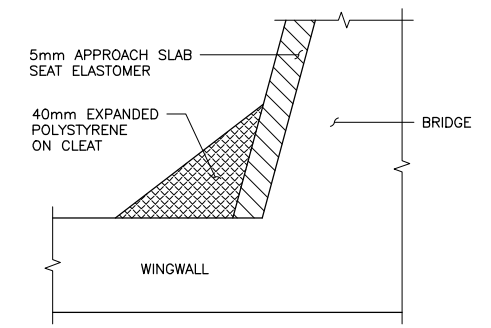

NOTES:

- CLEAR COVER TO REINFORCING STEEL 70 ± 20mm EXCEPT AS NOTED.
- REINFORCING STEEL SHALL BE GRADE 500W UNLESS SHOWN OTHERWISE ON GENERAL ARRANGEMENT.
- STAINLESS STEEL BARS SHALL BE TYPE 316 LN OR DUPLEX 2205 WITH A MINIMUM YIELD STRENGTH OF 500 MPa.
- WATERPROOFING AT JOINT BETWEEN BRIDGE AND APPROACH SLAB TO BE IN ACCORDANCE WITH OPSD 3370.100.
- DIMENSION "A" SHALL BE 50mm FOR TRANSITION BETWEEN SIDEWALK OR CURB ON BRIDGE TO CURB AND GUTTER AT APPROACH AND 105mm FOR TRANSITION FROM CONCRETE SAFETY-SHAPE BARRIER ON BRIDGE TO STEEL BEAM GUIDE RAIL AT APPROACHES.

APPLICABLE STANDARD DRAWINGS:

- OPSD 3370.100 DECK, WATERPROOFING HOT APPLIED ASPHALT MEMBRANE WITH PROTECTION BOARD.
 OPSD 3370.101 DECK, WATERPROOFING HOT APPLIED ASPHALT MEMBRANE AT ACTIVE CRACKS GREATER THAN 2mm WIDE AND CONSTRUCTION JOINTS.

NOTES TO DESIGNER:

- THIS STANDARD APPLIES INTEGRAL AND SEMI-INTEGRAL BRIDGES WITH MOVEMENT > 10mm AT END OF APPROACH SLABS.
- UPDATE PLAN TO REFLECT PARAPET WALL, BARRIER WALL, CURB, OR SIDEWALK AT EDGES OF APPROACH SLAB. UPDATE THE BARRIERS IN THE SECTION VIEWS TO MATCH THE BARRIERS USED ON THE BRIDGE.
- FOR SKEW GREATER THAN 20°, SPECIFY THE APPROACH SLAB LENGTH.
- SPECIFY TOP OF CONCRETE ELEVATIONS AT ALL TRANSITIONS IN CROSS-FALL.
- TO MEET REQUIREMENT OF THE ACCESSIBILITY FOR ONTARIANS WITH DISABILITIES ACT, 2005, WIDTH OF SIDEWALK FREE OF ANY LONGITUDINAL JOINT SHALL BE MINIMUM OF 1500mm.
- DELETE SECTIONS THAT DO NOT APPLY.
- 'NOTES TO DESIGNERS' SHALL BE DELETED PRIOR TO ISSUING THE CONTRACT.
- THE APPROACH SLAB SHALL BE LENGTHENED TO END BEYOND THE WINGWALL TO ALLOW DRAINAGE OF THE EXPANSION JOINT SEAL DOWN THE EMBANKMENT. IF LENGTHENING IS BEYOND 7000mm, THE MAIN BOTTOM REINFORCING STEEL SHALL BE INCREASED TO 20M @ 100 FOR LENGTHS UP TO 8000mm.
- CHASE NOT REQUIRED WHERE APPROACH SLAB IS NOT WATERPROOFED.

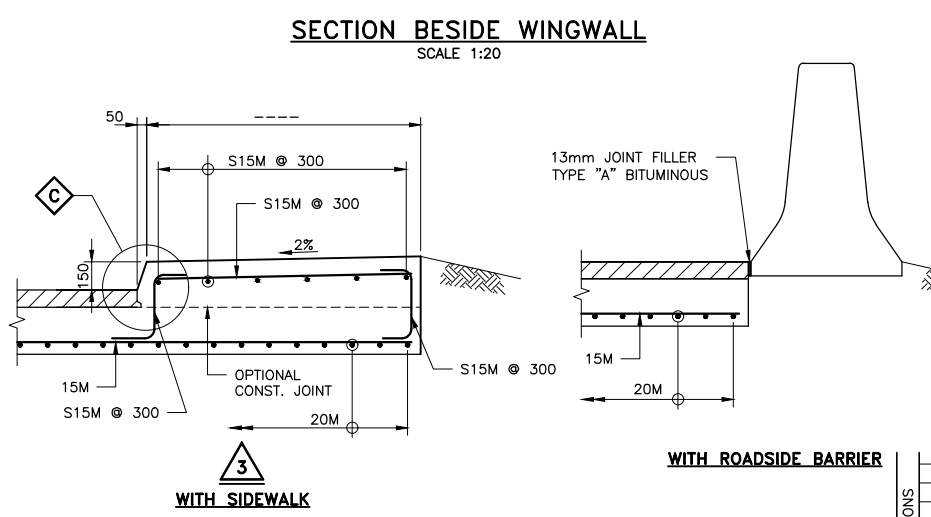
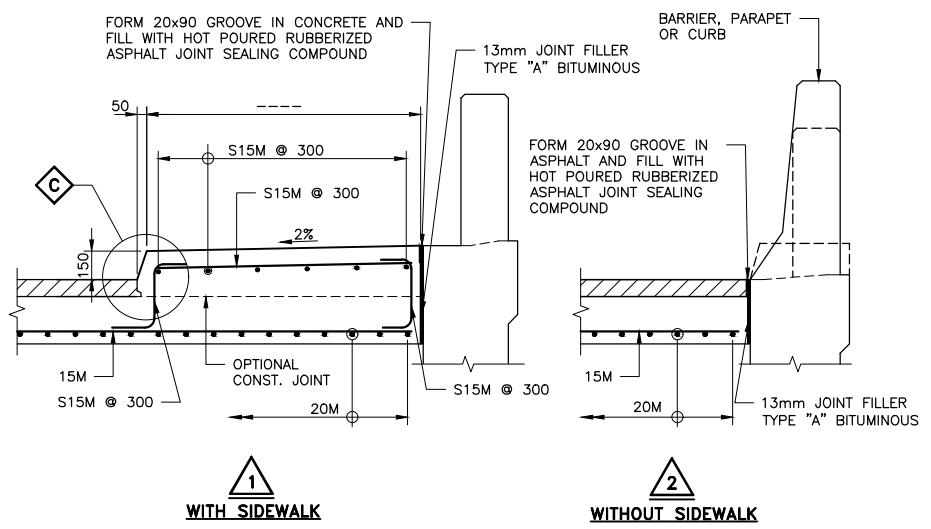
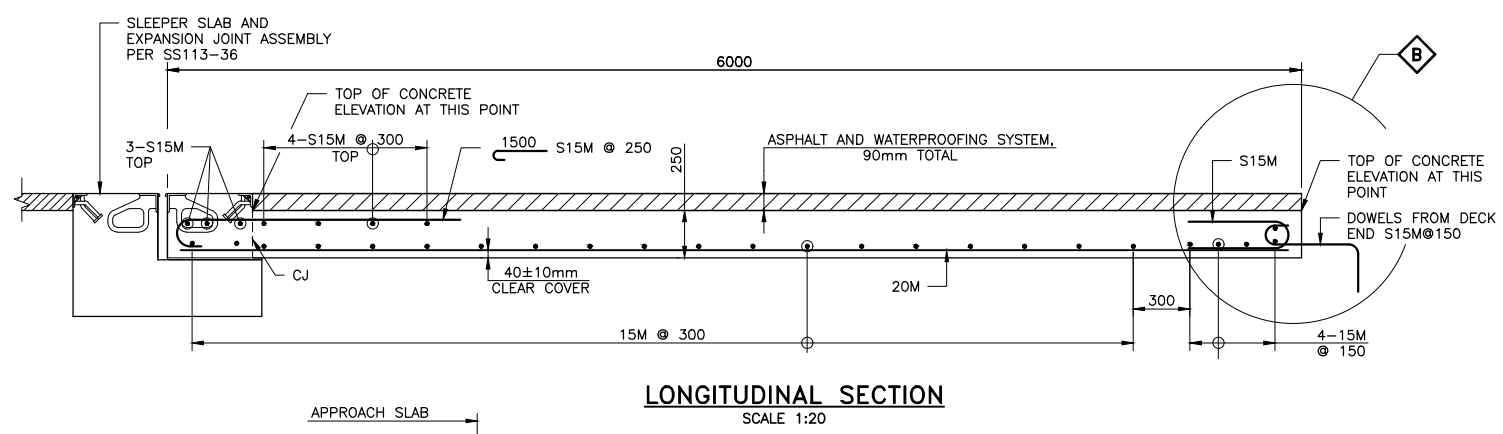

REFER TO THE STRUCTURAL MANUAL FOR PROFESSIONAL ENGINEER STAMPING REQUIREMENTS

STANDARD DRAWING
 JANUARY 2024
SS105-17
 APPROACH SLAB WITH SLEEPER SLAB

REVISIONS	DATE	BY	DESCRIPTION

DESIGN	CHK	CODE	CSA S6-19	LOAD	DATE
DRAWN	CHK	SITE			DWG

B
 SCALE 1:10

4
 WITHOUT SIDEWALK

3
 WITH SIDEWALK

WITH ROADSIDE BARRIER